



PRAYOSHHA  
**IMPRESS**  
2 & 3 BHK FLATS & SHOPS

More Happiness More Luxury



2,700 + HAPPY FAMILIES

Project Till Date 18 | 20+ Years of Experience

## ABOUT US

Prayosha Group is a modern construction company with traditional values. We prioritise family & their comfort. We believe in excellence & innovation and our projects are built on same belief. Prayosha Impress is our premium project, which demonstrated our level of expertise and originality.

## Prayosha Impress

2 & 3 BHK  
FLATS & SHOPS

2 & 3

BRICK



Imagine a space that gives you a feeling of tranquillity and a sense of achievement. For all the challenges that life throws at you, discover a place that feels like your very own fortress of peace and high-end living.





PRAYASHA  
**IMPRESS**  
2 & 3 BHK FLATS & SHOPS

IT'S TIME TO MAKE LIFE  
**LUXURIOUS**

Every corner of this fabulous project is adorned with high-end luxuries and beautiful elements of nature.  
Living here is an enchanting experience



Entrance Gate  
With Security Cabin



Basement +  
Ground Floor Parking.



Well Design  
Banquet Hall

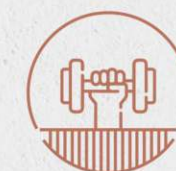

Indoor Gym Area

It's time to make life  
**EXCLUSIVE**

The grand entrance exuding a welcoming elegance greets you as you make your way into the realm of sheer affluence and bliss.

LEGENDS

- 01 Designer Entrance
- 02 Security Cabin
- 03 Seating Area
- 04 Soil Filling In Slope
- 05 Sculpture
- 06 Gazebo Sitting Area
- 07 Children Play Area
- 08 Temple
- 09 Senior Citizen Seating Area
- 10 Club Waiting Area
- 11 Entrance Foyer
- 12 Parking Space
- 13 Ramp To Basement Floor
- 14 Ramp Up To First Floor
- 15 Shop Wash Area
- 16 Shop Parking Space

Shop Area Table

SHOP	SIZE
01	14'-4½" X 22'-9"
02	8'-0" X 20'-9"
03	10'-0" X 20'-9"
04	9'-0" X 20'-9"
05	10'-0" X 20'-9"
06	12'-4½" X 20'-9"
07	10'-0" X 22'-9"
08	8'-0" X 20'-9"
09	10'-0" X 20'-9"
10	9'-0" X 20'-9"
11	10'-0" X 20'-9"
12	12'-4½" X 20'-9"
13	10'-0" X 22'-9"
14	9'-11" X 34'-9"
15	9'-11" X 34'-9"
16	10'-10" X 34'-9"
17	11'-7½" X 25'-1½"
18	12'-6" X 20'-9"
19	9'-0" X 20'-9"
20	10'-0" X 20'-9"
21	8'-0" X 25'-1½"
22	9'-0" X 25'-1½"
23	11'-0" X 25'-1½"
24	10'-9" X 25'-1½"



LEGENDS

- 01 Banquet Hall
- 02 Changing Room
- 03 Gents Washroom
- 04 Ladies Washroom
- 05 Gym Area
- 06 Bike Parking Space
- 07 Ramp To Ground Floor

Shop Area Table

SHOP	SIZE
101	14'-4½" X 22'-4½"
102	8'-0" X 12'-6"
103	10'-0" X 12'-6"
104	9'-0" X 12'-6"
105	10'-0" X 12'-6"
106	12'-4½" X 12'-6"
107	10'-0" X 14'-6"
108	8'-0" X 12'-6"
109	10'-0" X 12'-6"
110	9'-0" X 12'-6"
111	10'-0" X 12'-6"
112	12'-4½" X 12'-6"
113	10'-0" X 14'-6"
114	9'-11" X 26'-6"
115	9'-11" X 26'-6"
116	10'-10" X 26'-6"
117	11'-7½" X 16'-10½"
118	12'-6" X 12'-6"
119	9'-0" X 12'-6"
120	10'-0" X 12'-6"
121	8'-0" X 12'-6"
122	9'-0" X 16'-10½"
123	11'-0" X 16'-10½"
124	10'-8½" X 24'-9"





**11** Storey  
High & Residences





It's time to make life  
**Greener**

IT'S TIME TO MAKE LIFE  
**Happier**

There is no greater joy in the world but to see your children laugh, play and enjoy in abundance. There is more than enough space for them here to form innocent friendships and make sweet childhood memories



- Gazebo Sitting
- Children Play Area



IT'S TIME TO MAKE LIFE  
**Beautiful**

The colour green is wonderfully soothing, working its way from your eyes to your mind and body, taking you towards a sense of calmness and peace. Live your life surrounded by impeccably designed green spaces that take you towards serenity and away from the toll of stress.



- Temple
- Sitting Area



2 BHK  
Unit Floor Plan

3<sup>rd</sup> To 10<sup>th</sup> Typical Floor



2 BHK  
Unit Floor Plan

11<sup>th</sup> Typical Floor



A1 & A2 WING

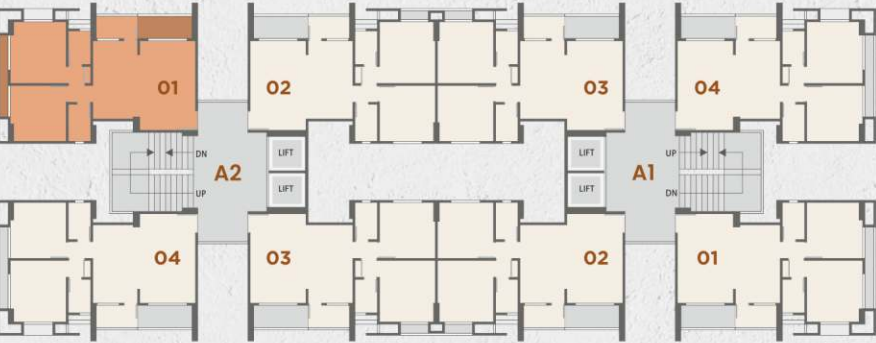

**PRAYASHA**  
**IMPRESS**  
2 & 3 BHK FLATS & SHOPS

A1 & A2 WING

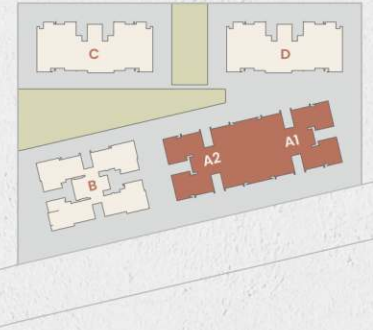
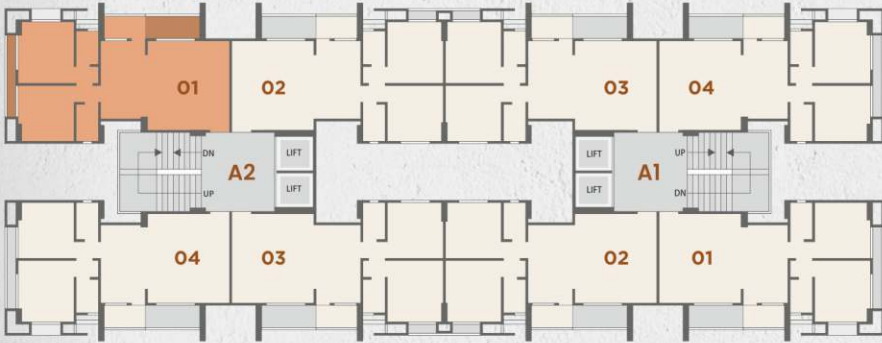

3 BHK  
Unit Floor Plan

3<sup>rd</sup> To 10<sup>th</sup> Typical Floor



3 BHK  
Unit Floor Plan

11<sup>th</sup> Typical Floor



B WING



PRAYASHA  
IMPRESS  
2 & 3 BHK FLATS & SHOPS

B WING



2 BHK  
Unit Floor Plan

1<sup>st</sup> To 10<sup>th</sup> Typical Floor



C & D WING



PASSAGE  
46'-4" X 8'-0"

DN



11<sup>th</sup> Typical Floor

2 BHK  
Unit Floor Plan

1<sup>ST</sup> To 11<sup>TH</sup> Typical Floor



C & D WING



**PRAYASHA**  
**IMPRESS**  
2 & 3 BHK FLATS & SHOPS

2 BHK  
Unit Floor Plan

1<sup>ST</sup> To 11<sup>TH</sup> Typical Floor





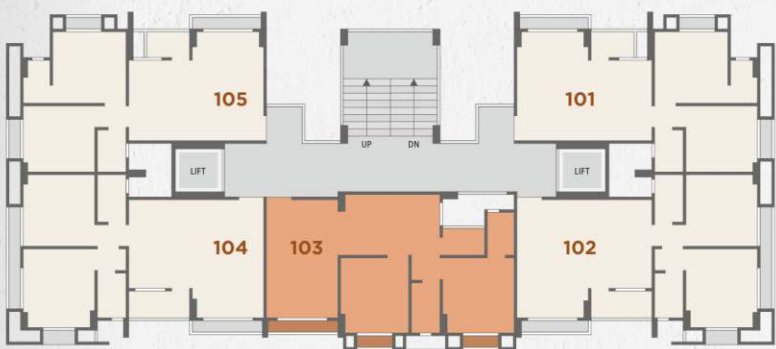





C & D WING



IT'S TIME TO MAKE LIFE  
**Supreme**



# UNITS SPECIFICATION

	Living Spaces	<ul style="list-style-type: none"><li>• Living / Kitchen &amp; Bedroom with Granamite Tiles.</li></ul>
	Kitchen	<ul style="list-style-type: none"><li>• Kitchen platform of granite stone with S.S. Sink Kitchen dado tiles up to lintel level.</li></ul>
	Bath & Toilet	<ul style="list-style-type: none"><li>• Elegantly designed toilet with designers tiles dado up to lintel level.</li></ul>
	Door & Window	<ul style="list-style-type: none"><li>• Designer main door with wooden frame.</li><li>• Internal doors with frame &amp; all others will be flush doors.</li><li>• Anodized / Powder coated aluminum section with reflective glass.</li></ul>
	Elevator	<ul style="list-style-type: none"><li>• 2 fully auto door elevators for each building.</li></ul>
	Plumbing	<ul style="list-style-type: none"><li>• Concealed plumbing with standard sanitary ware.</li><li>• C.P. Fittings UPVC pipes for water supply, PVC pipes for drainage.</li><li>• Centralized geyser provision point in wash area.</li><li>• Open drainage system with openable ceiling.</li></ul>
	Electrification	<ul style="list-style-type: none"><li>• Concealed circuit wiring with modular switches.</li><li>• M.C.B. in individual flat for safety.</li><li>• Electric points for T.V. and washing machine.</li></ul>
	Wall Finish	<ul style="list-style-type: none"><li>• All internal walls finished with putty.</li></ul>
	Façade Treatment	<ul style="list-style-type: none"><li>• Double coat plaster with paint and texture.</li></ul>

# CAMPUS FACILITY

- Compound wall and main gate with decorative lights.
  - Entrance foyer for each building.
  - Temple.
  - Well designed landscape garden.
- Fire safety provision as per the authority norms.
  - Supply of water municipal & auxiliary source from borewell.
  - Rooftop solar panel.
  - Power backup generator for common area of building.

### DISCLAIMER

• Premium quality materials or equivalent branded shall be used for all construction. • DGVC Charges, Legal charges and other Govt. Charges Shall be paid separately. • Maintenance deposit shall be paid separately. • Right of any changes in dimensions, design & specification will be reserved with the developer, which shall be binding for all members. • External changes strictly not allowed. • Stamp duty, registration fees, charges on allotment and possession of the property shall be borne by purchaser, applicable as per prevailing law. • Any additional liabilities due to change in the by laws, stamp duty govt. laws shall be borne by the members. • New rate will be applicable in case of delay in payment terms. Terms & condition will be as per separate agreement. • This brochure is meant only for information, presentation & guidance purposes, it is not an authorized document or an agreement. This does not form the basis of any contract. • Variation may occur as per local regulation and policy of improvement.

# LOCATION MAP

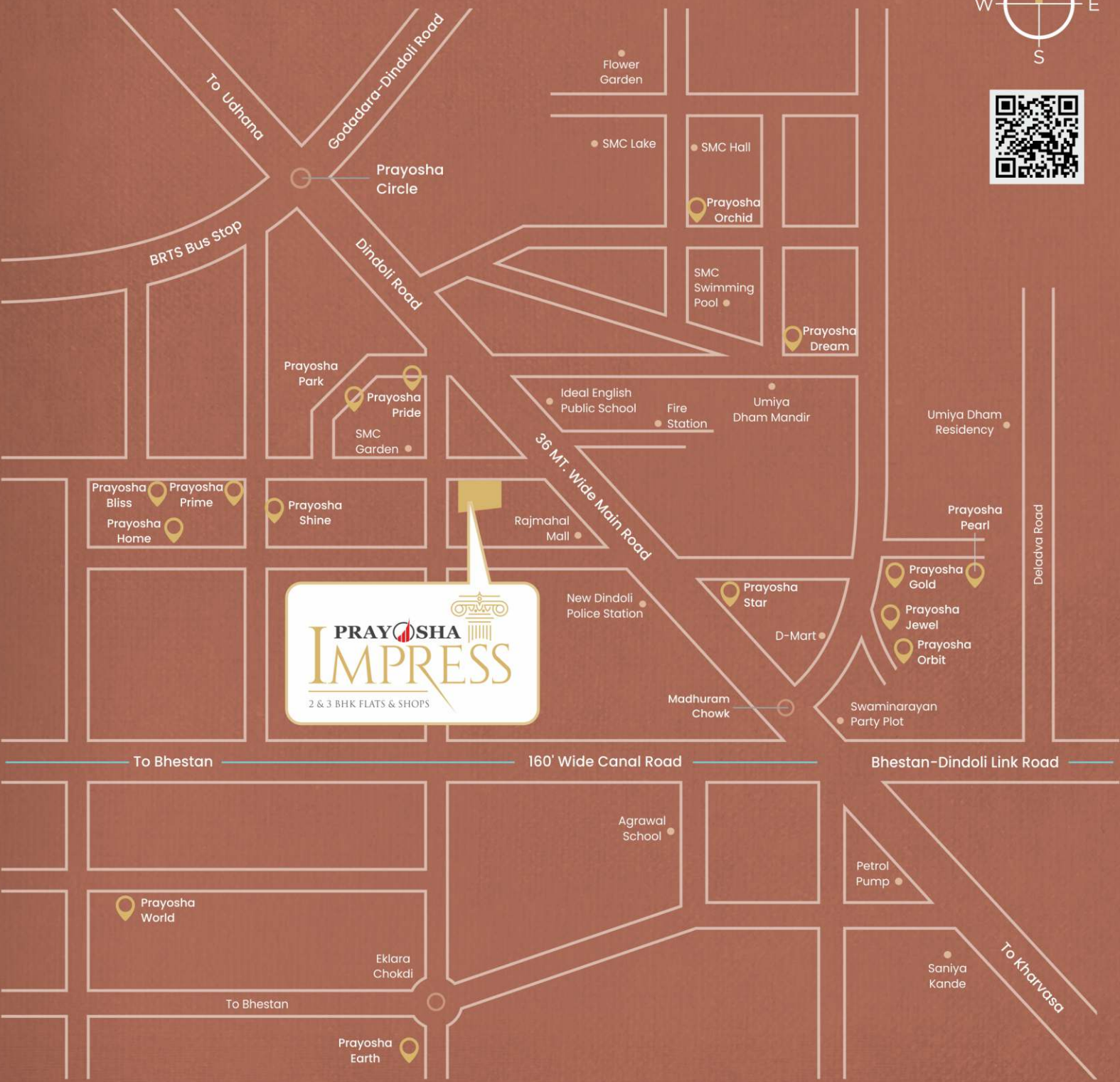

20 GLORIOUS YEARS OF BUILDING LANDMARKS

DEVELOPER SAVANI CORPORATION

ARCHITECT MINARC ASSOCIATES KANTILAL G. PATEL

STRUCTURAL AMIT K SHAH

LANDSCAPE, INTERIORS ZEN DESIGN STUDIO

MEMBER OF CREDAT SURAT

SITE ADDRESS Prayosha Impress, FP.58, TP.69, Near Millenium Park Society, Dindoli, Surat.

OFFICE ADDRESS Office-1, Prayosha Star, Opp. Uma Plaza, Kharvasa Road, Dindoli, Surat.

FOR INQUIRY 72280 51000 www.prayoshagroup.in

FOLLOW US ON prayoshasurat prayoshasurat prayoshagroup

A PROJECT BY :

**PRAYOSH**A  
We Build Relation

[www.prayoshagroup.in](http://www.prayoshagroup.in)

